

CIV In-Line Fan Range – CIV160-CIV500

The CIV fan range is an in-line centrifugal fan designed to fit into very confined spaces such as those encountered above fume cupboards, these fans are fitted with the same design impeller as the **(CMVeco)** range, an injection moulded 20 bladed Radial Tipped Fire retardant Polypropylene Impeller giving efficiencies of up to 65%, these impellers are balanced to ISO1940/1 - G2.5.

Motors are TEFC IP55 as standard and are mounted within a ventilated chamber, the motor is prewired to an external terminal box for ease of installation, fan casings are CNC machined from Black Polypropylene as standard.

There are currently 8 sizes within the range from Ø160 to Ø500 (we can produce other sizes if required) giving volumes between 100m³/hr - 13,000m³/hr with pressures up to 1100Pa.

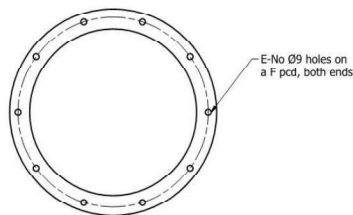
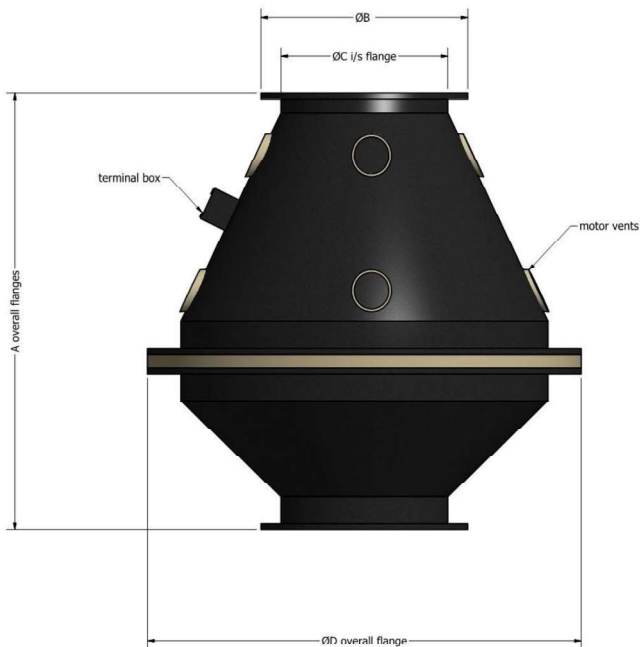

Fan Size	A	B	C	D	E	F
CIV160/160	550	220	160	550	8	195
CIV250/200	650	325	250	650	8	290
CIV250/225	650	325	250	650	8	290
CIV250/250	650	325	250	650	8	290
CIV315/280	750	400	315	800	12	360
CIV315/315	750	400	315	800	12	360
CIV400/400	950	500	400	1000	16	455
CIV500/500	1100	600	500	1100	20	556